



SCAN FOR INQUIRY

THE PRIME, AMBALI T JUNCTION, NR. YAKIL OVER BRIDGE, S P RING ROAD, AHMEDABAD-380058

7861 871 788 www.rashmiengicon.com

ARCHITECT



STRUCTURE



RERA NO. : PR/GJ/AHMEDABAD/AHMEDABAD CITY/AUDA/CAA12753/040124/311228 | GUJRERA.GUJARAT.GOV.IN

ID-11 des:ign > 975311965

R'ISING  
R'DEFINING  
R'RELIABLE

@ Ambli T Junction



**THE  
RELIABLE  
FOUNDATION**  
SINCE 1992

WHERE THERE IS RISING HORIZON OF OPPORTUNITIES. WHERE THERE IS A FOUNDATION FOR REDEFINING FUTURE. INTRODUCING RASHMI GROUP, DEVELOPING EXPLICABLE LANDMARKS THAT MEET THE EPITOMISES OF THE HIGHEST STANDARDS. WITH THE CORE VALUES OF RELIABLE TRUST, STRENGTH AND INNOVATION, WE ARE BUILDING SPACES TO DELIVER SUCCESS AND LIFESTYLE BEYOND ORDINARY.





# RASHMI THE PRIME

RETAIL & WORKING SPACE

FOR YOUR GROWING BUSINESS THAT DESERVES PROMINENT OFFICES AND RETAIL SPACES WHICH SIGNAL YOUR ASPIRATION AND COMMITMENT TOWARDS GROWTH, THE PRIME IS A NEW ADDRESS THAT MEET THE REQUIREMENTS OF SUCCESS.

@ Ambli  Junction

 ELENZA<sup>®</sup>  
GROUP



# R'ECIPROCATÉ

YOUR ORDINARY WORKPLACE  
WITH THE PRIME SPACES



14  
STOREY

15  
RETAILS

393  
OFFICES

OFFICES WITH  
TERRACE

BEAUTIFUL GLASS  
FACADE ELEVATION

MAIN ROAD FACING  
SHOWROOMS



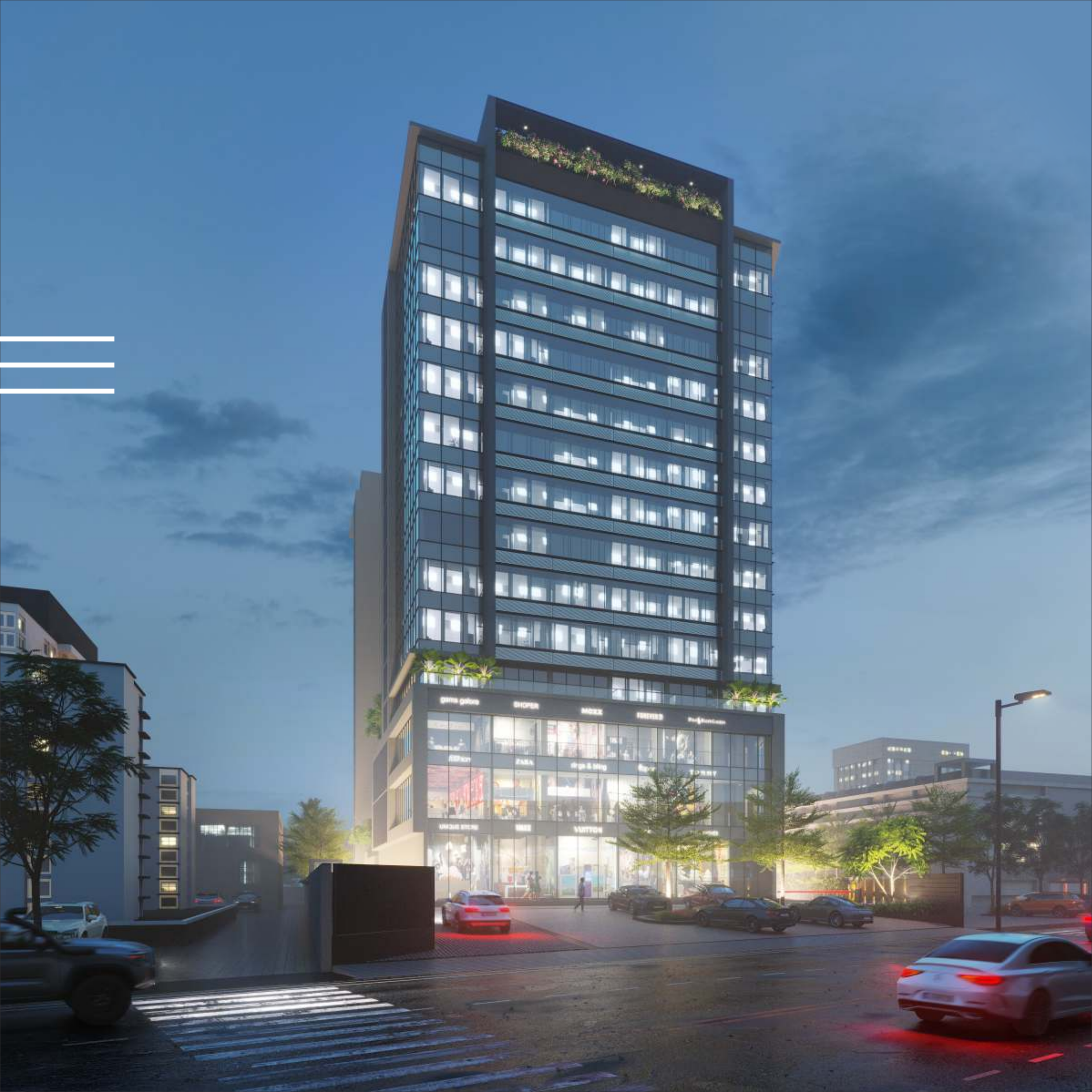

# R'ECOMMENCE

YOUR JOURNEY OF SUCCESS STARTS FROM HERE





# R'EVOLUTIONISE

THE PROXIMITY  
OF YOUR GROWTH

CRAFTED WITH  
UNCOMPROMISING  
QUALITY, THE PRIME IS  
DESIGNED TO ENABLE  
MORE PRODUCTIVITY AND  
MORE SPACE.

**LOCATED AT AMBLI T  
JUNCTION** THESE OFFICES  
AND RETAIL SPACES WILL  
STEP UP YOUR BUSINESS  
WITH SUCCESS





TERRACE CAFÉ



3 LEVEL BASEMENT PARKING



WAITING LOUNGE



VASTU COMPLIANT



8 HIGH SPEED ELEVATORS



FIRE SAFETY



HIGH-TECH SECURITY



CCTV SURVEILLANCE



# R'ECAPITULATE

YOUR SUCCESS WITH THE UTMOST VERSATILITY

# GROUND FLOOR



# FIRST FLOOR







FOURTH FLOOR



5<sup>TH</sup> TO 14<sup>TH</sup> FLOOR





#### STRUCTURE

- Earthquake resistant R.C.C. frame structure

#### ELECTRIFICATION

- Branded cable wiring & modular switches with
- I.S.I. standard fitting of good quality.

#### ELEVATORS

- 8 High speed elevators.
- One exclusive service elevator.
- Separate elevators for directors and owners.

#### DOOR

- 600mm X 600mm Vitrified tiles of standard make
- all area of each office and common passage.

#### WINDOW

- Anodized aluminium frames and Glass facade.

#### TOILETS

- Concealed plumbing fittings.
- Sanitary- Jaquar/Cera or equivalent.
- CP fittings- Jaguar or equivalent.

#### PAINT

- Weather resistant acrylic paint on exterior surface.
- Internal walls finished with wall putty.
- Acrylic paint on all common area & interior surface.

#### FIRE & SAFETY

- Fire hydrant & fire extinguisher system.

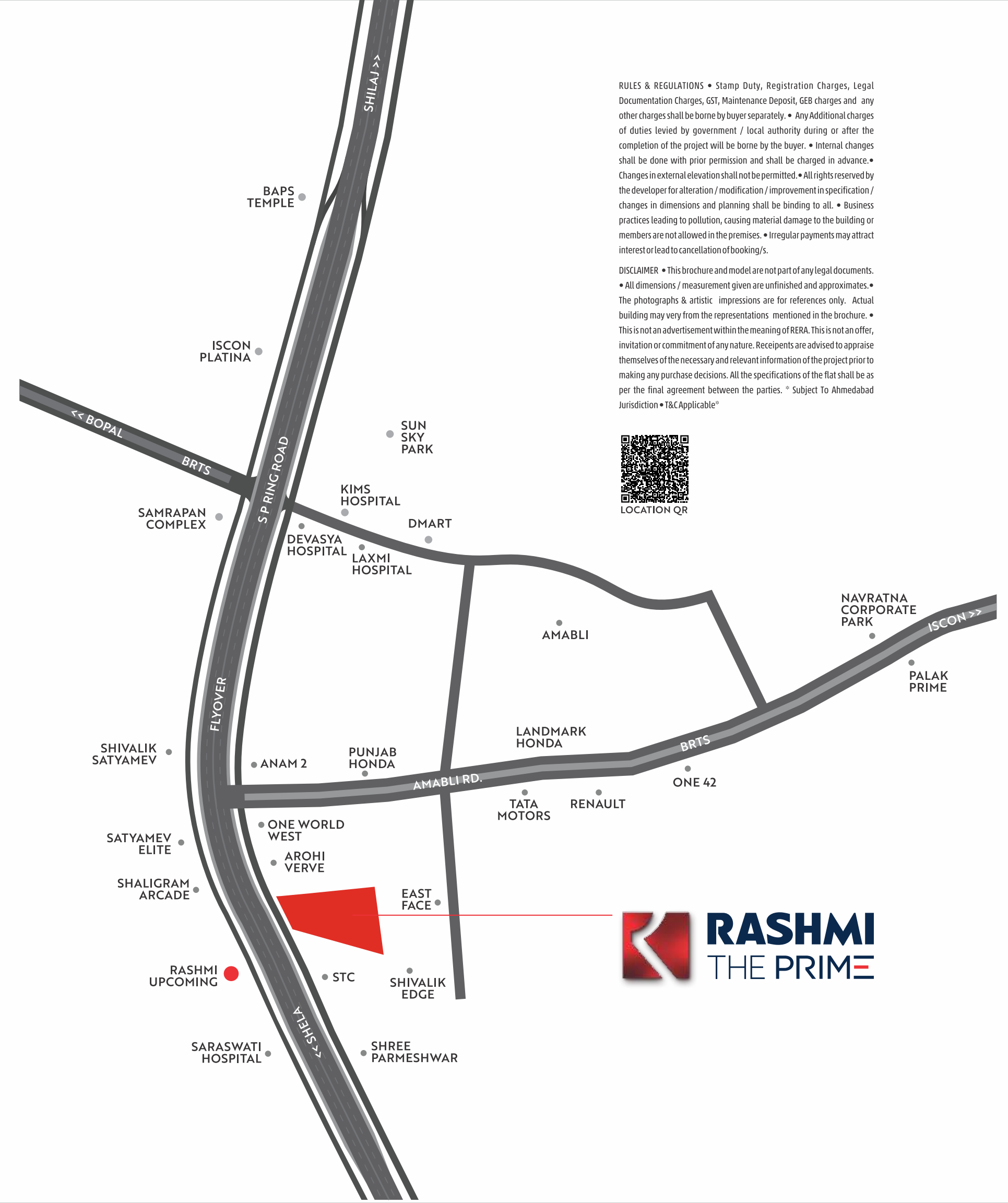

**RULES & REGULATIONS** • Stamp Duty, Registration Charges, Legal Documentation Charges, GST, Maintenance Deposit, GEB charges and any other charges shall be borne by buyer separately. • Any Additional charges of duties levied by government / local authority during or after the completion of the project will be borne by the buyer. • Internal changes shall be done with prior permission and shall be charged in advance. • Changes in external elevation shall not be permitted. • All rights reserved by the developer for alteration / modification / improvement in specification / changes in dimensions and planning shall be binding to all. • Business practices leading to pollution, causing material damage to the building or members are not allowed in the premises. • Irregular payments may attract interest or lead to cancellation of booking/s.

**DISCLAIMER** • This brochure and model are not part of any legal documents. • All dimensions / measurement given are unfinished and approximates. • The photographs & artistic impressions are for references only. Actual building may vary from the representations mentioned in the brochure. • This is not an advertisement within the meaning of RERA. This is not an offer, invitation or commitment of any nature. Receipts are advised to appraise themselves of the necessary and relevant information of the project prior to making any purchase decisions. All the specifications of the flat shall be as per the final agreement between the parties. \* Subject To Ahmedabad Jurisdiction • T&C Applicable\*



**RASHMI**  
THE PRIME